



HOME

SOUTHERN STAR WINDOWS

ASW300 SERIES SLIDING WINDOW
SUBJECT: INSTALLATION DETAILS - 1

TECHNICAL MANUAL

PAGE: ASW300.3.10.1

DATE: MAY 2013

HEAD DETAIL (CAVITY BRICKWORK)

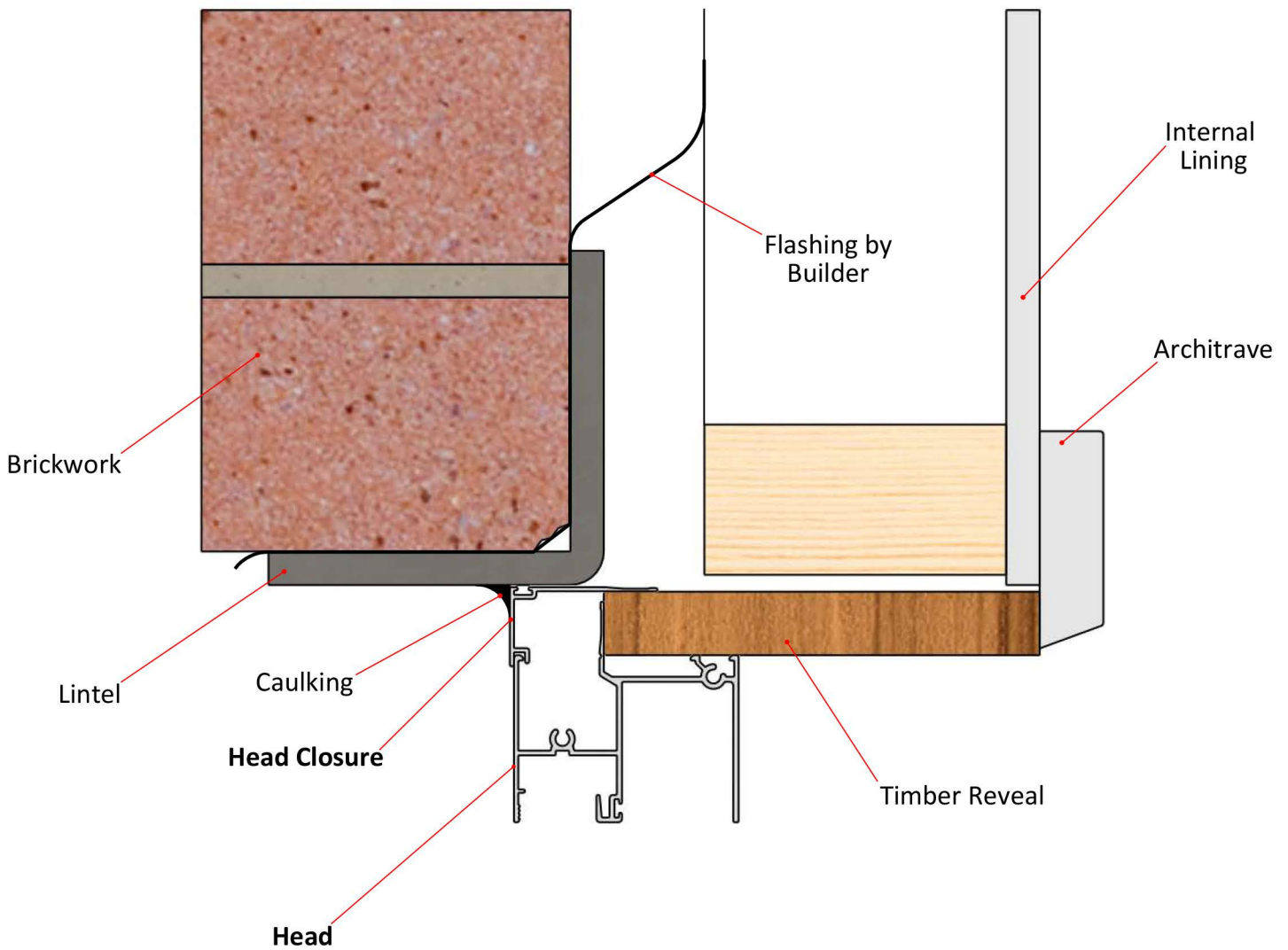



HOME

SOUTHERN STAR WINDOWS

ASW300 SERIES SLIDING WINDOW
SUBJECT: INSTALLATION DETAILS - 2

TECHNICAL MANUAL

PAGE: ASW300.3.10.2

DATE: MAY 2013

SILL DETAIL (CAVITY BRICKWORK)

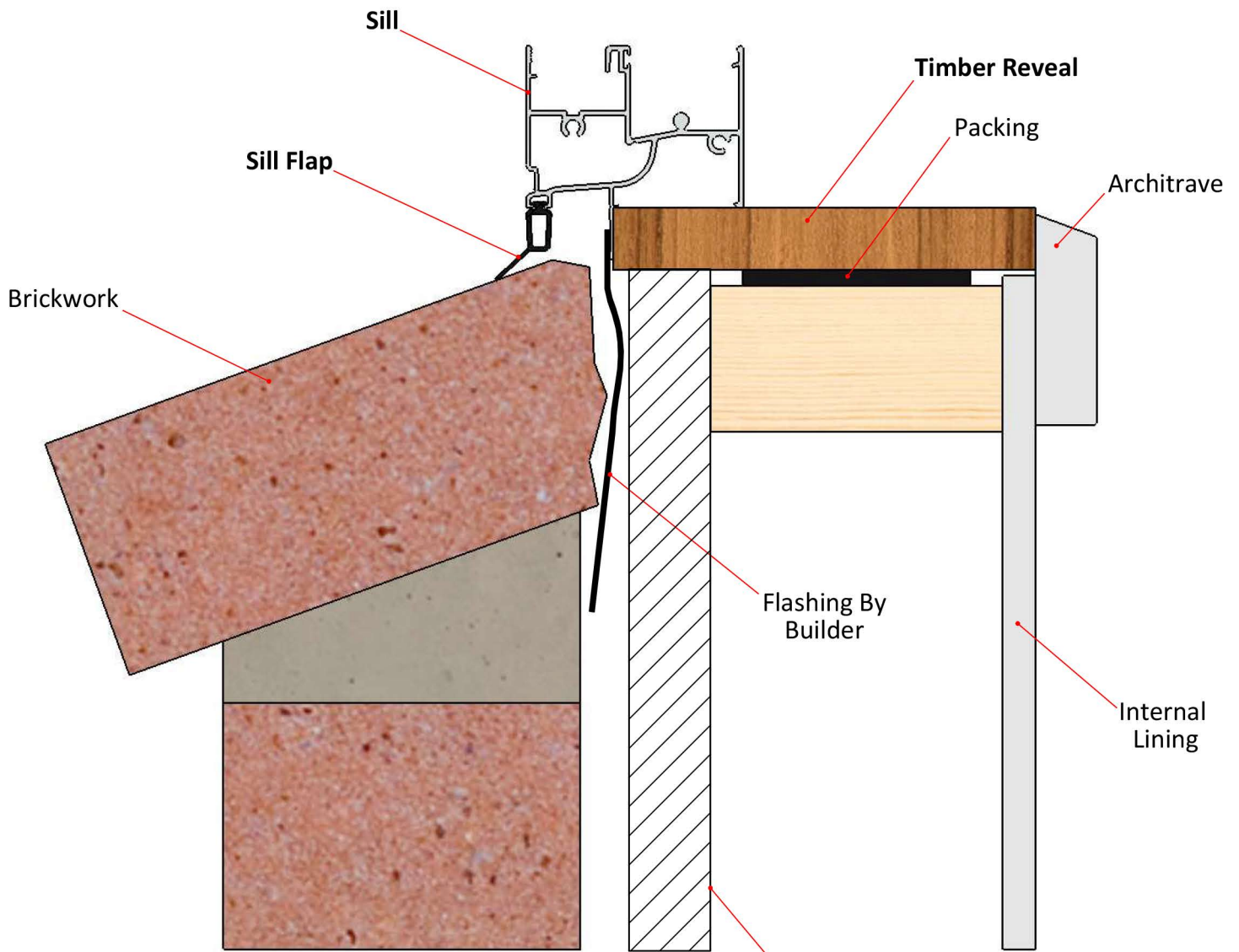

Provide additional support
for all DG windows and all
windows over 1800 wide
(by builder)



HOME

SOUTHERN STAR WINDOWS

ASW300 SERIES SLIDING WINDOW

SUBJECT: INSTALLATION DETAILS - 3

TECHNICAL MANUAL

PAGE: ASW300.3.10.3

DATE: MAY 2013

JAMB DETAIL (CAVITY BRICKWORK)

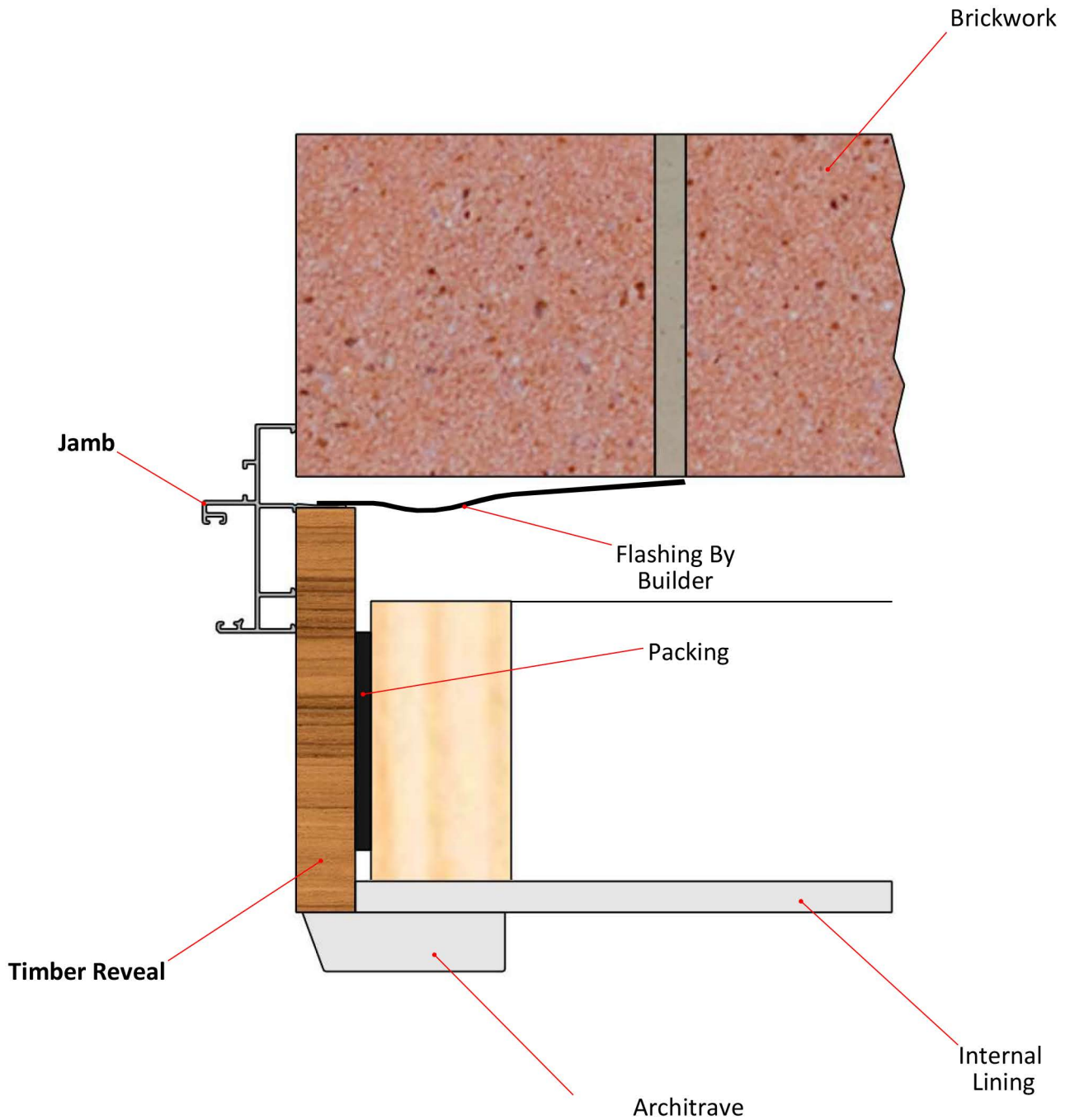



HOME

SOUTHERN STAR WINDOWS

ASW300 SERIES SLIDING WINDOW
SUBJECT: INSTALLATION DETAILS - 4

TECHNICAL MANUAL

PAGE: ASW300.3.10.4

DATE: MAY 2013

HEAD DETAIL (WEATHERBOARDS)

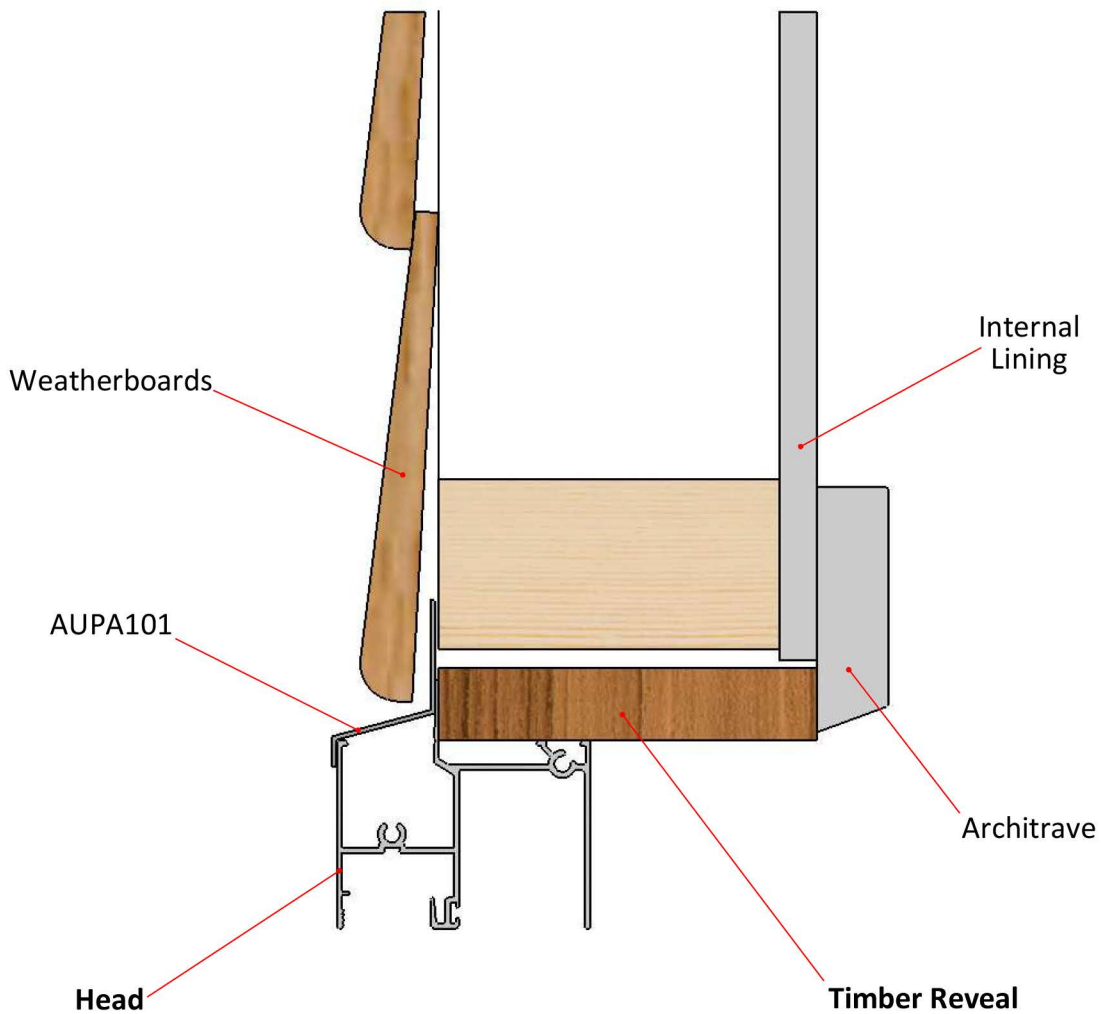



HOME

SOUTHERN STAR WINDOWS

ASW300 SERIES SLIDING WINDOW
SUBJECT: INSTALLATION DETAILS - 5

TECHNICAL MANUAL

PAGE: ASW300.3.10.5

DATE: MAY 2013

SILL DETAIL (WEATHERBOARDS)

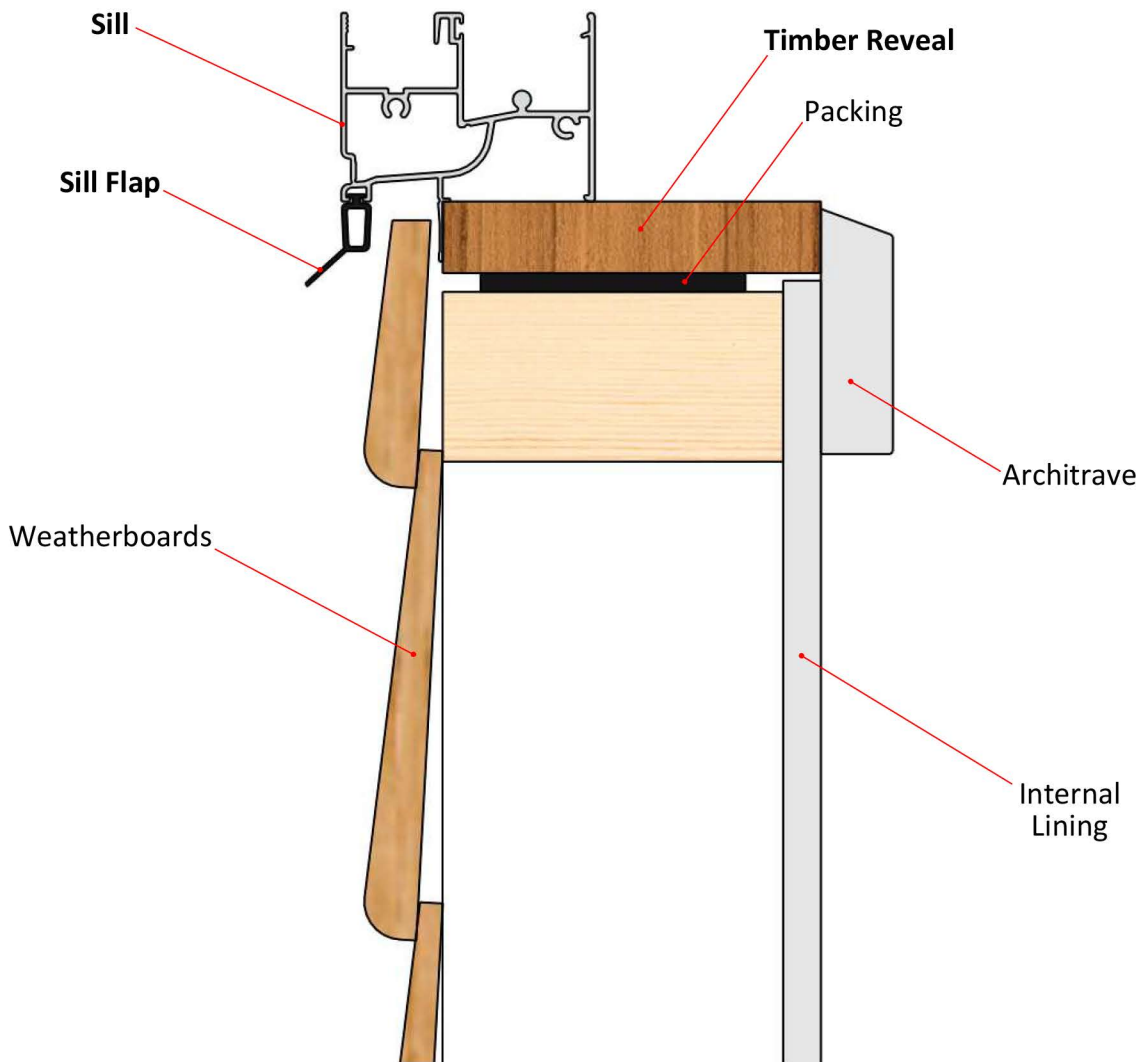



HOME

SOUTHERN STAR WINDOWS

ASW300 SERIES SLIDING WINDOW

SUBJECT: INSTALLATION DETAILS - 6

TECHNICAL MANUAL

PAGE: ASW300.3.10.6

DATE: MAY 2013

JAMB DETAIL (WEATHERBOARDS)

